

SECTION OR SUBDIVISION

36/31
1/6

CORNER No.

53

TWP. 141 N., RANGE 9410 E., W.M.

CORNER DESCRIPTION

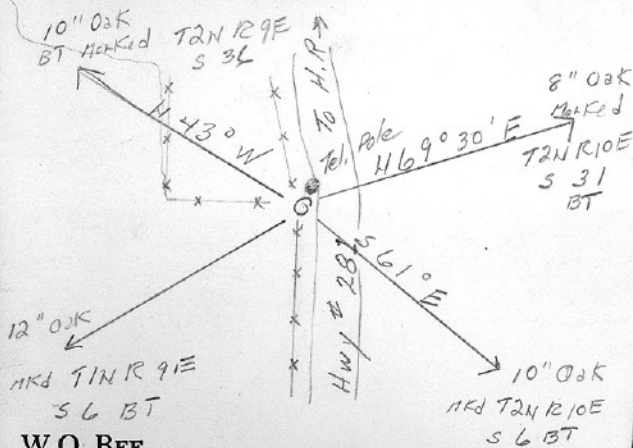

See J44 10J p. 11-12

Flat Rock in Fence.

Corner Identified by
Paul Winans 5-25-60Note: BT's may be
marked correctly. This
info taken from fieldNotes: Geo. Fry Survey
Brass cap set in con.

post by Geo. Fry 1963?

BEARING STUMPS FOUND (Fry 10/26/60)

18" stump NORTH S^E

18" stump S20°E 4°

CARD..... OF.....

OVER

Fry 10-26-60

included:

1 1/2 I.P. stamped by COR.

SECTION OR SUBDIVISION

Township corner

CORNER No.

53

TWP. 2N, 1N, RANGE 9E, 10E, W.M.

CORNER DESCRIPTION

36	31
1	6

NW 6, 1N 10

NE 1, 1N 9

SE 36, 2N 9

SW 31, 2N 10

8" Oak bears N44°W 14'

12" Oak bears S20°W 77'

8" Oak bears N70°E 61'

6" Oak bears S60°E 65'

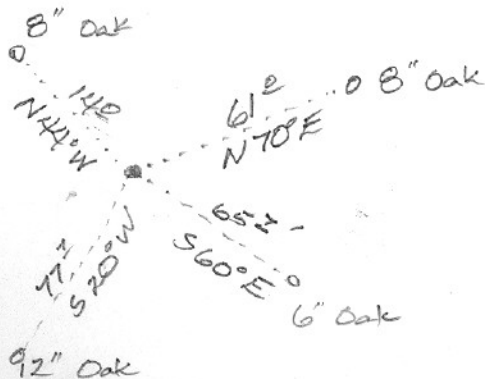

W.O. REF. _____

Reset in 1979 to 1960 position following disturbance
by St. Hwy Division.

CARD.....

OF