

20064165

(1)

After recording:
Hood River County Surveyor
918 Eighteenth Street
Hood River, OR 97031

STATE OF OREGON } SS
 COUNTY OF HOOD RIVER }
 I certify that this instrument was received
 and recorded in the records of said county.
 Sandra E. Berry, Director of records and
 Assessment and Ex-Officio Recorder.
 by: Sandra E. Berry Deputy.
 DOC#: 20064165
 RCPT: 51039 JUN 26.00
 8/21/2006 4:00 PM

AFFIDAVIT OF CORRECTION

I, Paul W. Perry, P.L.S. No. 58587 LS, being duly sworn, depose and say that I am the surveyor who surveyed the Partition Plat as depicted, filed and recorded on May 22, 2006, as Partition Plat No. 200613-P, Hood River County Records.

The following corrections to said survey are necessary and are as follows:

1.) The monument at the northeast corner of Parcel 2 was offset N88°15'39"W, 1.00 feet.

A brass screw with 3/4" diameter brass washer inscribed "HPR INC" was set in the following locations:

- 2.) The southeast corner of Parcel 1 on the west right-of-way line of Frankton Road.
- 3.) The monument N01°41'52"E, 28.99 feet northerly of the southeast corner of Parcel 1 on the west right-of-way line of Frankton Road.
- 4.) The north end of a 1402.39 foot radius curve, 61.21 feet in length on the west right-of-way line of Frankton Road.
- 5.) The east end of a 25.00 foot radius curve, on the north line of Parcel 1, 19.75 feet in length.
- 6.) The west end of a 25.00 foot radius curve, on the north line of Parcel 1, 19.75 feet in length.
- 7.) The west end of a line S88°19'49"E, 32.00 feet in length on the west line of Parcel 1.
- 8.) The south end of a 20.00 foot radius curve, on the east line of Parcel 2, 13.17 feet in length.
- 9.) The north end of a 20.00 foot radius curve, on the east line of Parcel 2, 13.17 feet in length.
- 10.) The north end of a line N39°47'18"W, 75.37 feet in length on the west line of Parcel 2.
- 11.) The northeast end of a line S53°56'15"W, 31.71 feet in length, being the most-easterly corner of Parcel 3.
- 12.) The west end of a line S89°25'15"E, 62.58 feet in length, being the most-easterly north line of Boulder Court.

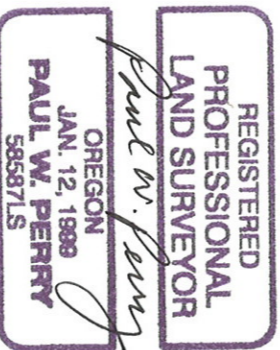

Paul W. Perry
 Paul W. Perry
 Harper, Houf, Peterson, Righellis, Inc.
 5200 S.W. Macadam Ave., Suite. 580
 Portland, Oregon 97239

Renewal date: 12/31/06

NOTARY CERTIFICATE

STATE OF OREGON)
) ss
 COUNTY OF HOOD RIVER)
 Multnomah)

Signed and sworn to before me on this 8 day of August, 2006, by Paul W. Perry.

Ann C. Schumacher
 Notary Public for the State of Oregon



COUNTY SURVEYOR APPROVAL

Approved this 15th day of August, 2006, in accordance with ORS 92.070.

Randy Johnston
 Randy Johnston, PLS
 Hood River County Surveyor